

IIVI INFRARED

... the world leader in CO₂ laser optics

CO₂ LASER NOZZLES AND ACCESSORIES

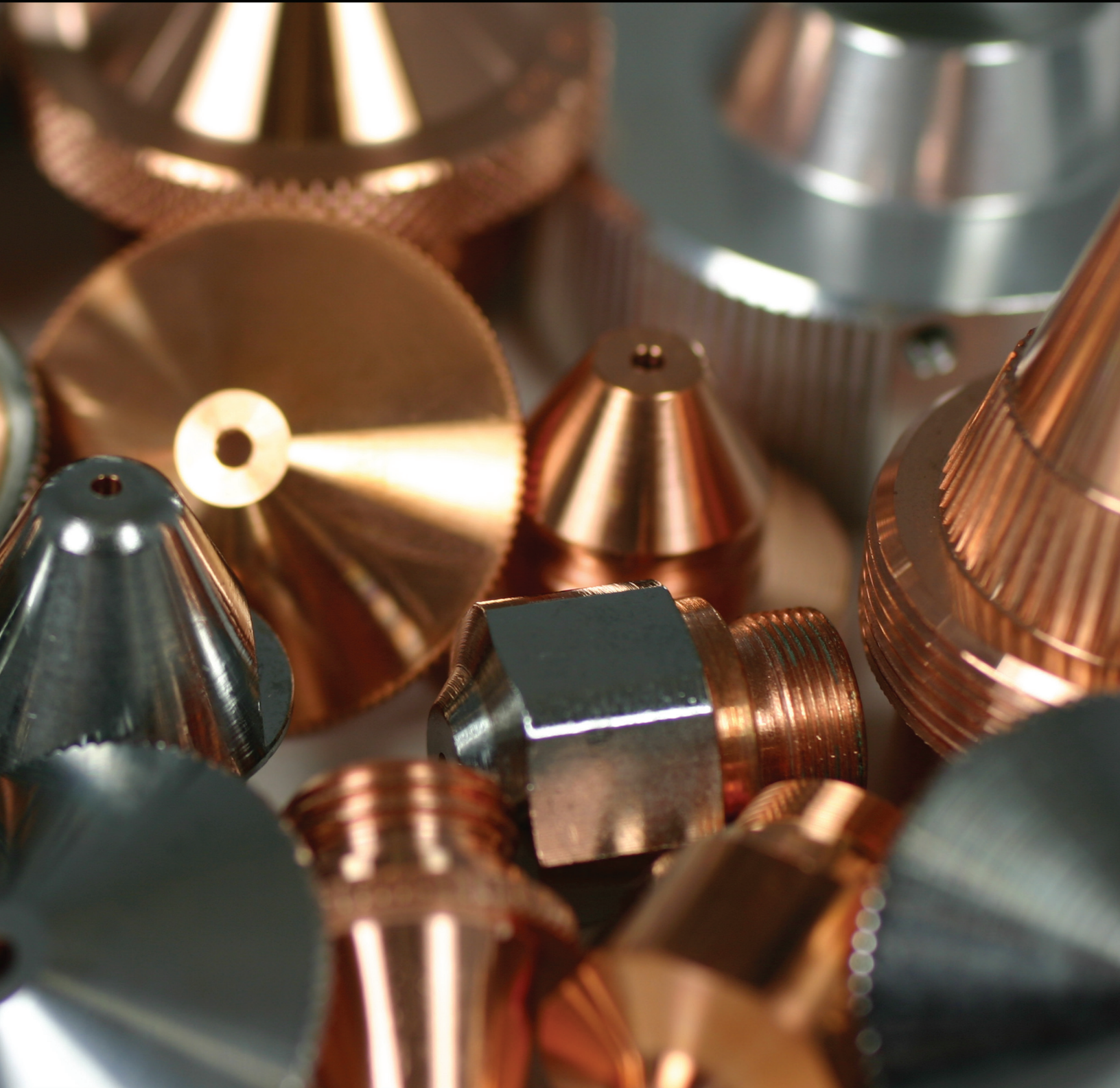

FOR AMADA LASERS

888.558.1504 (toll-free) • 724.352.1504 (phone) • 724.352.4980 (fax) • www.iivinfrared.com

IIVI

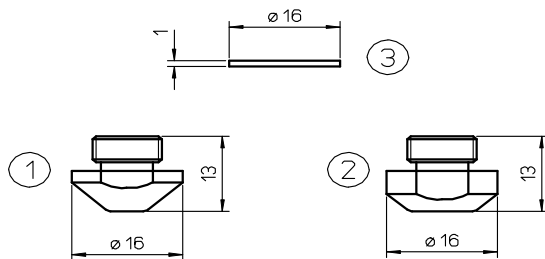

POS	II-VI p/n	OEM p/n	DESCRIPTION
1	L171X	62094006	AMADA® NOZZLE Ø 1.0 CP
	L30171X	62094006	AMADA® NOZZLE Ø 1.0 CP -- package contains 10 pcs
	L172X	62094006	AMADA® NOZZLE Ø 1.25 CP
	L30172X	62094006	AMADA® NOZZLE Ø 1.25 CP -- package contains 10 pcs
	L173X	62094006-1507610	AMADA® NOZZLE Ø 1.5 CP
	L30173X	62094006-1507610	AMADA® NOZZLE Ø 1.5 CP -- package contains 10 pcs
	L174X	62094006	AMADA® NOZZLE Ø 1.75 CP
	L30174X	62094006	AMADA® NOZZLE Ø 1.75 CP -- package contains 10 pcs
	L27X	62094006-1507611	AMADA® NOZZLE Ø 2.0 CP
	L3027X	62094006-1507611	AMADA® NOZZLE Ø 2.0 CP -- package contains 10 pcs
	L175X	62094006	AMADA® NOZZLE Ø 2.5 CP
	L30175X	62094006	AMADA® NOZZLE Ø 2.5 CP -- package contains 10 pcs
	L28X	62094008-71102007	AMADA® NOZZLE Ø 3.0 CP
	L3028X	62094008-71102007	AMADA® NOZZLE Ø 3.0 CP -- package contains 10 pcs
2	L750X	62094005	AMADA® NOZZLE Ø 1.0 CP
	L30750X	62094005	AMADA® NOZZLE Ø 1.0 CP -- package contains 10 pcs
	L751X	62094005	AMADA® NOZZLE Ø 1.25 CP
	L30751X	62094005	AMADA® NOZZLE Ø 1.25 CP -- package contains 10 pcs
	L752X	62094005-71341515	AMADA® NOZZLE Ø 1.5 CP
	L30752X	62094005-71341515	AMADA® NOZZLE Ø 1.5 CP -- package contains 10 pcs
	L753X	62094005-71341515-1,75	AMADA® NOZZLE Ø 1.75 CP
	L30753X	62094005-71341515-1,75	AMADA® NOZZLE Ø 1.75 CP -- package contains 10 pcs
	L754X	62094005-71102006	AMADA® NOZZLE Ø 2.0 CP
	L30754X	62094005-71102006	AMADA® NOZZLE Ø 2.0 CP -- package contains 10 pcs
	L755X	62094005	AMADA® NOZZLE Ø 2.5 CP
	L30755X	62094005	AMADA® NOZZLE Ø 2.5 CP -- package contains 10 pcs
	L756X	62094005-71341515-3,0	AMADA® NOZZLE Ø 3.0 CP
	L30756X	62094005-71341515-3,0	AMADA® NOZZLE Ø 3.0 CP -- package contains 10 pcs
3	AL107	62094006-ring	AMADA® DISC HEAD PROTECTION Ø 16 PLASTIC

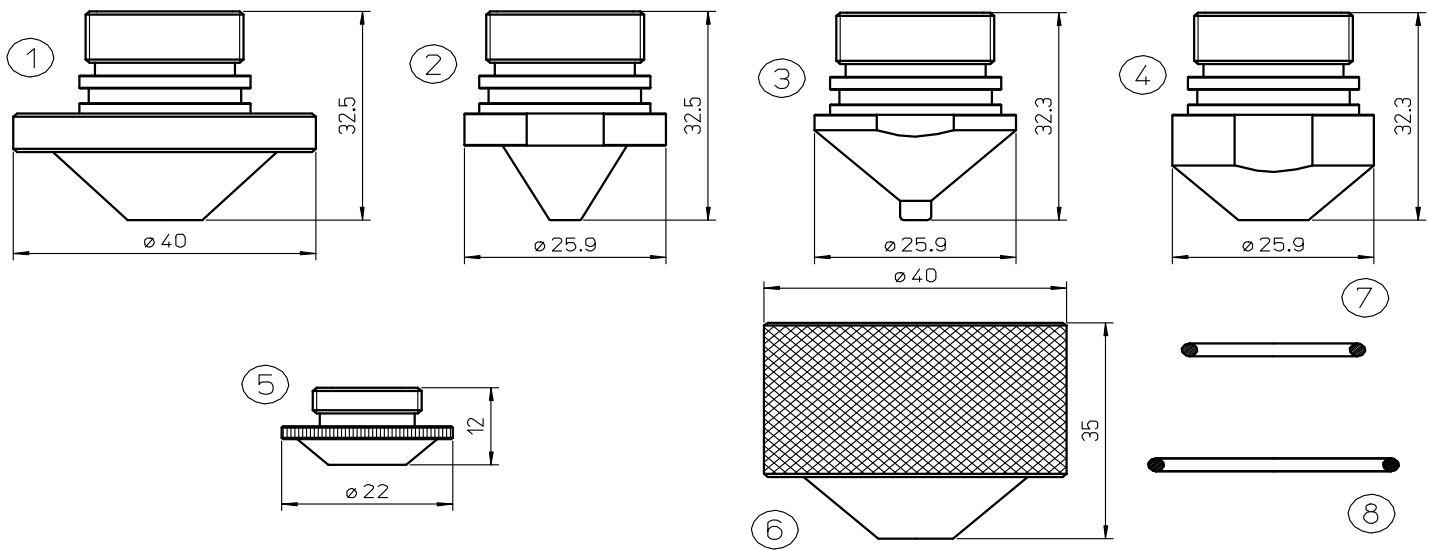

SEE NEXT PAGE (PG. 4) FOR PART NUMBERS

POS	II-VI p/n	OEM p/n	DESCRIPTION
1	L896X	71101000	AMADA® NOZZLE CLEAN CUT Ø 1.5
	L897X	71102000	AMADA® NOZZLE CLEAN CUT Ø 1.75
	L898X	71101999	AMADA® NOZZLE CLEAN CUT Ø 2.0
	L899X	71101999	AMADA® NOZZLE CLEAN CUT Ø 2.5
2	L81X	6506892	AMADA® NOZZLE Ø 1.3 CP
	L92X	6506892	AMADA® NOZZLE Ø 1.5 CP
	L93X	6506892	AMADA® NOZZLE Ø 1.8 CP
	L39X	74712001-6506892	AMADA® NOZZLE Ø 2.0 CP
3	L63X	71101901	AMADA® NOZZLE Ø 1.3 CP
	L91X	71101902	AMADA® NOZZLE Ø 1.5 CP
	L75X	71101901	AMADA® NOZZLE Ø 1.8 CP
	L29X	71101901-845735	AMADA® NOZZLE Ø 2.0 CP
	L809X		AMADA® NOZZLE Ø 2.5 CP
	L808X	71101901	AMADA® NOZZLE Ø 3.0 CP
4	L297X		AMADA® NOZZLE Ø 1.3 CP
	L298X	62094001-71102001	AMADA® NOZZLE Ø 1.5 CP
	L299X	62094001-71102001	AMADA® NOZZLE Ø 1.8 CP
	L300X	62094001-71102001	AMADA® NOZZLE Ø 2.0 CP
	L301X	62094002-71102005	AMADA® NOZZLE Ø 3.0 CP
5	L85X		AMADA® NOZZLE Ø 1.0 CP
	L94X		AMADA® NOZZLE Ø 1.25 CP
	L95X		AMADA® NOZZLE Ø 1.5 CP
	L96X		AMADA® NOZZLE Ø 1.75 CP
	L38X	74718816-8249301	AMADA® NOZZLE Ø 2.0 CP
6	L30X	71101905-841143B	AMADA® NOZZLE OUTER CP
7	AL90	S-20	AMADA® O'RING FOR NOZZLE S-20 - 10 PCS
8	AL96	1AS-34	AMADA® O'RING FOR NOZZLE OUTER

SEE PREVIOUS PAGE (PG. 3) FOR PART DRAWINGS

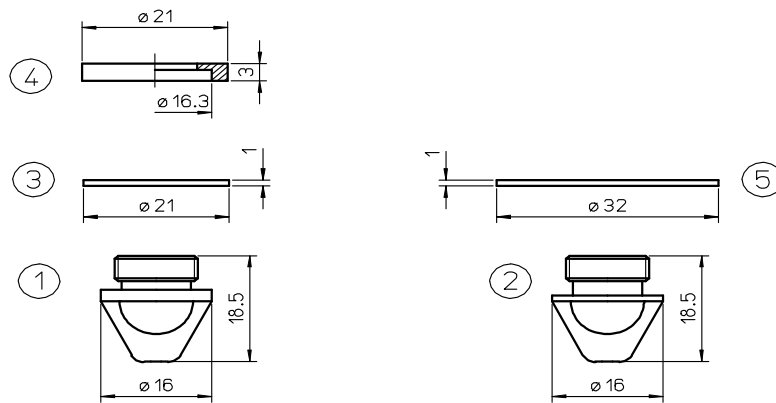

SEE NEXT PAGE (PG. 6) FOR PART NUMBERS

POS	II-VI p/n	OEM p/n	DESCRIPTION
1	L760X		AMADA® NOZZLE Ø 0.8 CP
	L30760X		AMADA® NOZZLE Ø 0.8 CP -- package contains 10 pcs
	L134X	1664545U	AMADA® NOZZLE Ø 1.0 CP
	L30134X	1664545U	AMADA® NOZZLE Ø 1.0 CP -- package contains 10 pcs
	L135X	1664545U	AMADA® NOZZLE Ø 1.25 CP
	L30135X	1664545U	AMADA® NOZZLE Ø 1.25 CP -- package contains 10 pcs
	L86X	1664545U	AMADA® NOZZLE Ø 1.5 CP
	L3086X	1664545U	AMADA® NOZZLE Ø 1.5 CP -- package contains 10 pcs
	L136X	1664545U	AMADA® NOZZLE Ø 1.75 CP
	L30136X	1664545U	AMADA® NOZZLE Ø 1.75 CP -- package contains 10 pcs
	L137X	1664644U-71341610	AMADA® NOZZLE Ø 2.0 CP
	L30137X	1664644U-71341610	AMADA® NOZZLE Ø 2.0 CP -- package contains 10 pcs
	L203X	1664545U	AMADA® NOZZLE Ø 2.5 CP
	L30203X	1664545U	AMADA® NOZZLE Ø 2.5 CP -- package contains 10 pcs
	L138X	1664645U-71360142	AMADA® NOZZLE Ø 3.0 CP
	L30138X	1664645U-71360142	AMADA® NOZZLE Ø 3.0 CP -- package contains 10 pcs
	L339X		AMADA® NOZZLE Ø 4.0 CP
	L30339X		AMADA® NOZZLE Ø 4.0 CP -- package contains 10 pcs
	L763X		AMADA® NOZZLE Ø 5.0 CP
	L30763X		AMADA® NOZZLE Ø 5.0 CP -- package contains 10 pcs
2	L192X		AMADA® NOZZLE Ø 1.0 CP
	L30192X		AMADA® NOZZLE Ø 1.0 CP -- package contains 10 pcs
	L193X		AMADA® NOZZLE Ø 1.25 CP
	L30193X		AMADA® NOZZLE Ø 1.25 CP -- package contains 10 pcs
	L194X		AMADA® NOZZLE Ø 1.5 CP
	L30194X		AMADA® NOZZLE Ø 1.5 CP -- package contains 10 pcs
	L195X		AMADA® NOZZLE Ø 1.75 CP
	L30195X		AMADA® NOZZLE Ø 1.75 CP -- package contains 10 pcs
	L196X		AMADA® NOZZLE Ø 2.0 CP
	L30196X		AMADA® NOZZLE Ø 2.0 CP -- package contains 10 pcs
	L197X		AMADA® NOZZLE Ø 2.5 CP
	L30197X		AMADA® NOZZLE Ø 2.5 CP -- package contains 10 pcs
	L198X		AMADA® NOZZLE Ø 3.0 CP
	L30198X		AMADA® NOZZLE Ø 3.0 CP -- package contains 10 pcs
3	AL1005	71341614	AMADA® DISC HEAD PROTECTION Ø 21 PLASTIC
	AL122	71341614	AMADA® DISC HEAD PROTECTION Ø 21 VESPEL
4	AL123		AMADA® DISC HEAD PROTECTION Ø 21 CERAMIC
5	AL42		AMADA® DISK HEAD PROTECTION Ø 32 PLASTIC

SEE PREVIOUS PAGE (PG. 5) FOR PART DRAWINGS

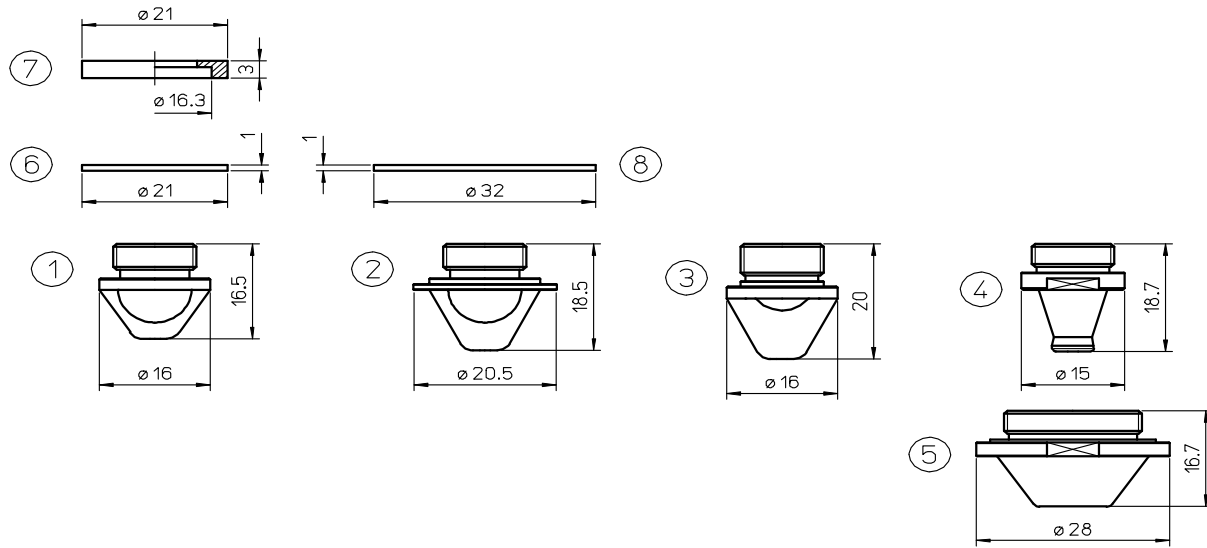

POS	II-VI p/n	OEM p/n	DESCRIPTION
1	L338X		AMADA® NOZZLE Ø 3.0 CP - SHORT
2	L1066X L1068X		AMADA® NOZZLE Ø 2.0 LARGE FLANGE AMADA® NOZZLE Ø 3.0 LARGE FLANGE
3	L1285X L1287X	71341770-1667110	AMADA® NOZZLE Ø 2.0 AMADA® NOZZLE Ø 3.0
4	L926X L927X L928X L933X L929X L930X L931X L932X	71398902 - 1034-00-5-1	AMADA® NOZZLE HP-X Ø 0.8 CP AMADA® NOZZLE HP-X Ø 1.0 CP AMADA® NOZZLE HP-X Ø 1.2 CP AMADA® NOZZLE HP-X Ø 1.4 CP AMADA® NOZZLE HP-X Ø 1.5 CP AMADA® NOZZLE HP-X Ø 2.0 CP AMADA® NOZZLE HP-X Ø 2.5 CP AMADA® NOZZLE HP-X Ø 3.0 CP
5	AL220X		AMADA® NOZZLE OUTER HP-X CP
6	AL1005 AL122	71341614 71341614	AMADA® DISC HEAD PROTECTION Ø 21 PLASTIC AMADA® DISC HEAD PROTECTION Ø 21 VESPEL
7	AL123		AMADA® DISC HEAD PROTECTION Ø 21 CERAMIC
8	AL42		AMADA® DISK HEAD PROTECTION Ø 32 PLASTIC

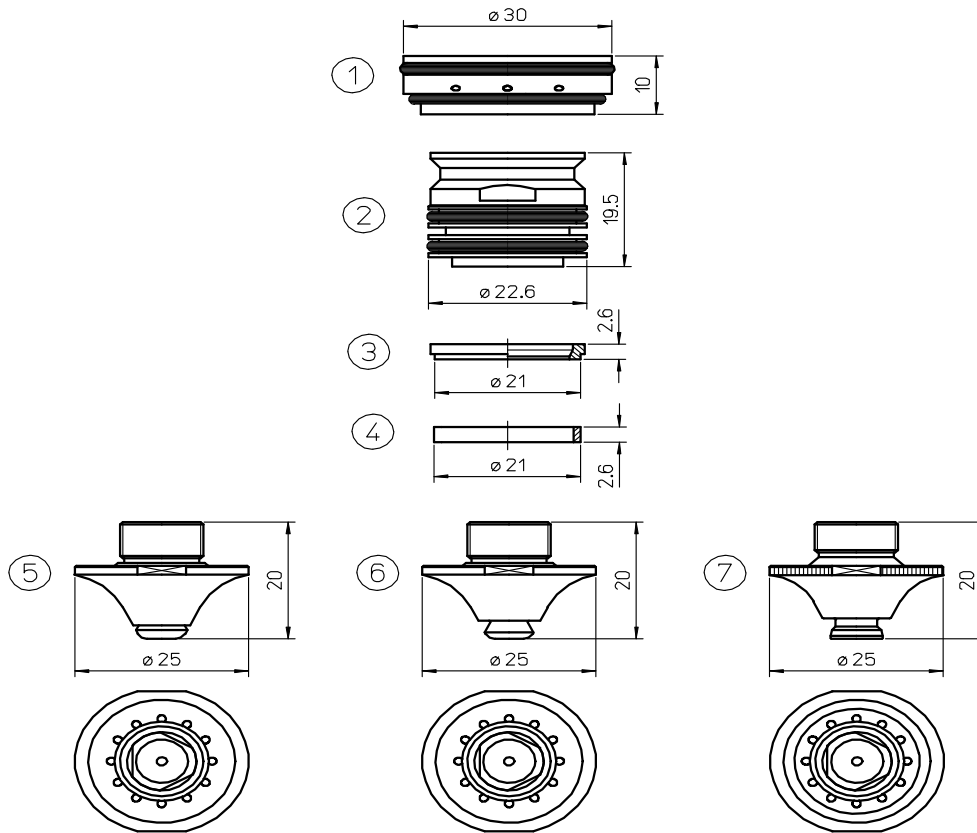

POS	II-VI p/n	OEM p/n	DESCRIPTION
1	AL340	71502026	AMADA® TEFLON INSULATOR FOR ADAPTOR
2	AL248	71502036	AMADA® NOZZLE ADAPTOR WITH HOLES
	AL268		AMADA® KIT O-RINGS FOR AL248
3	AL233		AMADA® TEFLON O-RING FOR WATER COOLED SYST. RIGID VERSION
4	AL234	71515853	AMADA® TEFLON RING FOR WATER COOLED SYSTEM
5	L1155X	71502039	AMADA® DOUBLE NOZZLE Ø 2.5 CP WITH HOLES
	L1159X	71502040	AMADA® DOUBLE NOZZLE Ø 4.0 CP WITH HOLES
6	L1041X		AMADA® DOUBLE NOZZLE Ø 1.4 CP WITH HOLES
	L1043X		AMADA® DOUBLE NOZZLE Ø 1.7 CP WITH HOLES
	L1044X		AMADA® DOUBLE NOZZLE Ø 2.0 CP WITH HOLES
	L1045X	71502039	AMADA® DOUBLE NOZZLE Ø 2.5 CP WITH HOLES
	L1049X	71502040	AMADA® DOUBLE NOZZLE Ø 4.0 CP WITH HOLES
	L1050X		AMADA® DOUBLE NOZZLE Ø 5.0 CP WITH HOLES
7	L1355X	71502039 - 1576400A	AMADA® DOUBLE NOZZLE Ø 2.5 CP WITH HOLES
	L1359X	71712336 - 71461158	AMADA® DOUBLE NOZZLE Ø 4.0 CP WITH HOLES

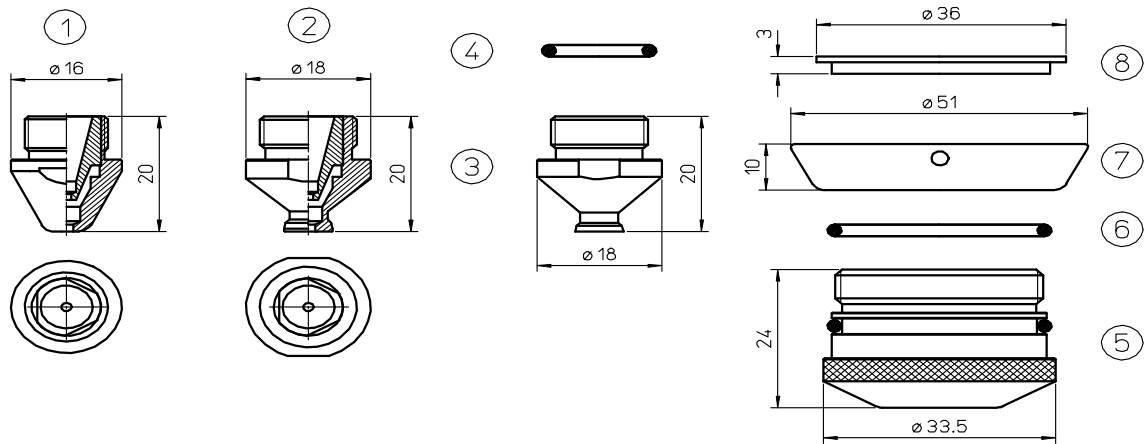

SEE NEXT PAGE (PG. 10) FOR PART NUMBERS

POS	II-VI p/n	OEM p/n	DESCRIPTION
1	L390X	1669864-7134162	AMADA® DOUBLE NOZZLE Ø 1.0 CP
	L392X	1669864-7134162	AMADA® DOUBLE NOZZLE Ø 1.2 CP
	L393X	1669864-7134162	AMADA® DOUBLE NOZZLE Ø 1.4 CP
	L391X	1669864-7134162	AMADA® DOUBLE NOZZLE Ø 1.5 CP
	L780X	1669864-7134162	AMADA® DOUBLE NOZZLE Ø 1.8 CP
	L315X	1669864-7134162	AMADA® DOUBLE NOZZLE Ø 2.0 CP
	L316X	1669864-7134162	AMADA® DOUBLE NOZZLE Ø 2.5 CP
	L317X	1669864-7134163	AMADA® DOUBLE NOZZLE Ø 3.0 CP
	L768X	1669864-7134162	AMADA® DOUBLE NOZZLE Ø 3.5 CP
	L319X	1669864-7134162	AMADA® DOUBLE NOZZLE Ø 3.8 CP
	L318X	1669795-71341681	AMADA® DOUBLE NOZZLE Ø 4.0 CP
WATER COOLED			
2	L387X	6551218-71341682	AMADA® DOUBLE NOZZLE Ø 1.0 CP
	L386X	6551218-71341682	AMADA® DOUBLE NOZZLE Ø 1.2 CP
	L389X	6551218-71341682	AMADA® DOUBLE NOZZLE Ø 1.4 CP
	L388X	6551218-71341682	AMADA® DOUBLE NOZZLE Ø 1.5 CP
	L764X	6551218-71341682	AMADA® DOUBLE NOZZLE Ø 1.7 CP
	L320X	6551218-71341682	AMADA® DOUBLE NOZZLE Ø 2.0 CP
	L321X	6551218-71341682	AMADA® DOUBLE NOZZLE Ø 2.5 CP
	L322X	6551218-71341682	AMADA® DOUBLE NOZZLE Ø 3.0 CP
	L323X	6551218-71341682	AMADA® DOUBLE NOZZLE Ø 3.8 CP
	L330X	6551218-71341682	AMADA® DOUBLE NOZZLE Ø 4.0 CP
	L781X	6551218-71341682	AMADA® DOUBLE NOZZLE Ø 5.0 CP
3	L384X	71366090	AMADA® NOZZLE Ø 1.0 CP
	L765X	71366090	AMADA® NOZZLE Ø 1.2 CP
	L766X	71366090	AMADA® NOZZLE Ø 1.4 CP
	L385X	71366090	AMADA® NOZZLE Ø 1.5 CP
	L324X	71366090	AMADA® NOZZLE Ø 2.0 CP
	L325X	71366090	AMADA® NOZZLE Ø 2.5 CP
	L326X	71366090	AMADA® NOZZLE Ø 3.0 CP
	L327X	71366090	AMADA® NOZZLE Ø 3.8 CP
	L767X	71366090	AMADA® NOZZLE Ø 4.0 CP
4	AL93	S-14	AMADA® O'RING FOR NOZZLE - 10 PCS
5	AL115X	71366452-71341684-6551148A	AMADA® NOZZLE OUTER CP
6	AL94	71366453	AMADA® O'RING FOR NOZZLE OUTER
7	AL180	71366438	AMADA® GUARD NUT
8	AL181	71366437	AMADA® GUARD RING

SEE PREVIOUS PAGE (PG. 9) FOR PART DRAWINGS

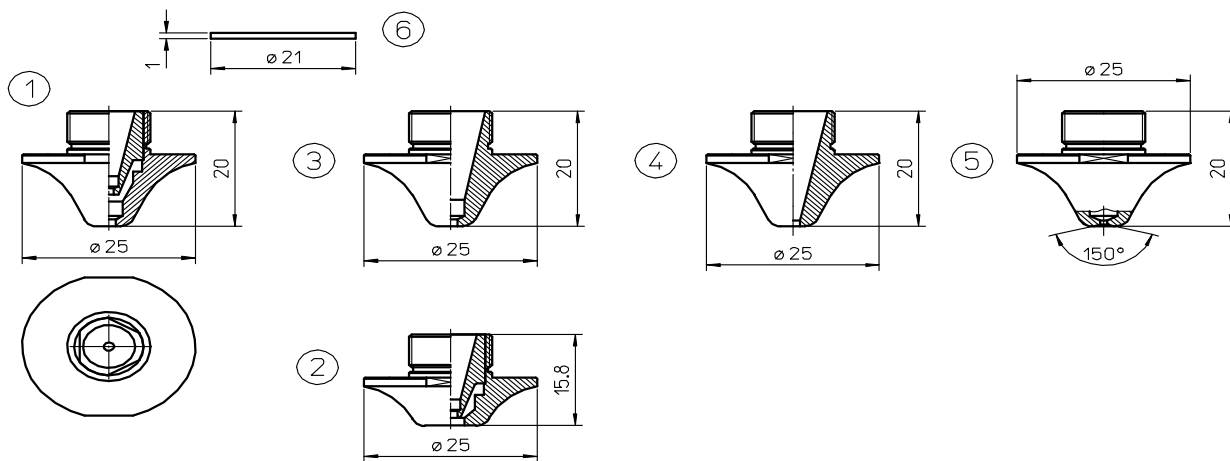

SEE NEXT PAGE (PG. 12) FOR PART NUMBERS

POS	II-VI p/n	OEM p/n	DESCRIPTION
1	L585X	1572361	AMADA® DOUBLE NOZZLE Ø 1.2 CP
	L586X	71369813-71502038-71518550-71341779	AMADA® DOUBLE NOZZLE Ø 1.4 CP
	L574X	1572361-71518548-1572380	AMADA® DOUBLE NOZZLE Ø 1.7 CP
	L587X	1572361	AMADA® DOUBLE NOZZLE Ø 2.0 CP
	L584X	71501059-71515394-71516789-1576398	AMADA® DOUBLE NOZZLE Ø 2.5 CP
	L588X	1572361	AMADA® DOUBLE NOZZLE Ø 3.0 CP
	L589X	71501060-71515395-71516790-1576399	AMADA® DOUBLE NOZZLE Ø 4.0 CP
	L583X	1572361	AMADA® DOUBLE NOZZLE Ø 5.0 CP
	L569X		AMADA® DOUBLE NOZZLE Ø 6.0 CP
2	L565X		AMADA® DOUBLE NOZZLE SHORT Ø 4.0 CP
	L567X		AMADA® DOUBLE NOZZLE SHORT Ø 5.0 CP
	L568X		AMADA® DOUBLE NOZZLE SHORT Ø 6.0 CP
3	L590X	1572362	AMADA® NOZZLE Ø 0.8 CP
	L591X	1572362	AMADA® NOZZLE Ø 1.0 CP
	L592X	71369812-	AMADA® NOZZLE Ø 1.2 CP
	L593X	1572362	AMADA® NOZZLE Ø 1.4 CP
	L597X	1572362 - 71501056 - 1572368B	AMADA® NOZZLE Ø 1.5 CP
	L575X	1572362	AMADA® NOZZLE Ø 1.7 CP
	L594X	71501057 - 71515392	AMADA® NOZZLE Ø 2.0 CP
	L572X		AMADA® NOZZLE Ø 2.5 CP
	L595X	71501058 - 71515393	AMADA® NOZZLE Ø 3.0 CP
	L596X	1572362	AMADA® NOZZLE Ø 4.0 CP
4	L1027X		AMADA® NOZZLE STRAIGHT TAPER Ø 0.8 CP
	L1028X		AMADA® NOZZLE STRAIGHT TAPER Ø 1.0 CP
	L1029X		AMADA® NOZZLE STRAIGHT TAPER Ø 1.2 CP
	L1030X		AMADA® NOZZLE STRAIGHT TAPER Ø 1.4 CP
	L599X		AMADA® NOZZLE STRAIGHT TAPER Ø 1.5 CP
	L598X		AMADA® NOZZLE STRAIGHT TAPER Ø 2.0 CP
	L571X		AMADA® NOZZLE STRAIGHT TAPER Ø 3.0 CP
5	L1031X	71502038-1576396A	AMADA® DOUBLE NOZZLE Ø 1.4 CP W/CONCAVE
	L1024X		AMADA® NOZZLE Ø 0.8 CP W/CONCAVE
	L1025X		AMADA® NOZZLE Ø 1.0 CP W/CONCAVE
	L1026X	71502037	AMADA® NOZZLE Ø 1.2 CP W/CONCAVE
6	AL1005	71341614	AMADA® DISC HEAD PROTECTION Ø 21 PLASTIC
	AL122	71341614	AMADA® DISC HEAD PROTECTION Ø 21 VESPEL

SEE PREVIOUS PAGE (PG. 11) FOR PART DRAWINGS

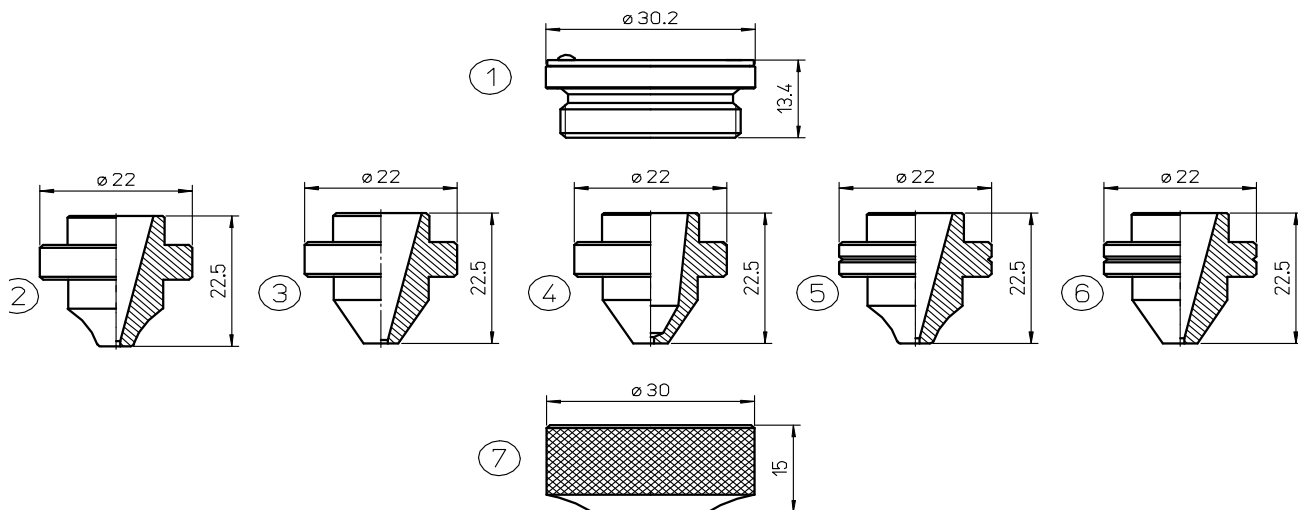

POS	II-VI p/n	OEM p/n	DESCRIPTION
1	AL267	P0594-860-00001	PRECITEC® NOZZLE HOLDER IT HP2" MZP/MEL
2	L1126	71800016A0-BQ933D283H01	AMADA® - MITSUBISHI® NOZZLE Ø 1.0 WITH RADIUS NO GROOVE
3	L1134	71800018 - BQ943D157H01	AMADA® - MITSUBISHI® NOZZLE Ø 1.5
	L1131		AMADA® - MITSUBISHI® NOZZLE Ø 1.7
	L1135	71800019 - BQ943D157H02	AMADA® - MITSUBISHI® NOZZLE Ø 2.0
	L1136	71800020 - BQ943D157H03	AMADA® - MITSUBISHI® NOZZLE Ø 2.5
	L1137	71800021- BQ943D157H04	AMADA® - MITSUBISHI® NOZZLE Ø 3.0
	L1138	71800022 - BQ943D596H01	AMADA® - MITSUBISHI® NOZZLE Ø 3.5
	L1139		AMADA® - MITSUBISHI® NOZZLE Ø 4.0
	L1140X	71800109-BQ943D714H01- W18Q94371401	AMADA® - MITSUBISHI® NOZZLE Ø 4.0 CP FOR FOCUS POINT
4	L1125	71800016-BQ943D897H01- W18Q94389701	AMADA® - MITSUBISHI® HV NOZZLE Ø 1.0
	L1128	W18Q93309101	AMADA® - MITSUBISHI® HV NOZZLE Ø 2.5
	L1129	W18Q93309102	AMADA® - MITSUBISHI® HV NOZZLE Ø 3.0
5	L1130	71800017-BQ943D269H01- W18Q93326901	AMADA® - MITSUBISHI® HV NOZZLE Ø 1.2 WITH RADIUS
6	L1132	W18Q93302701	AMADA® - MITSUBISHI® HV NOZZLE Ø 1.7
7	AL269	71800026 - BQ933D94H01	AMADA® - MITSUBISHI® NOZZLE NUT SHORT

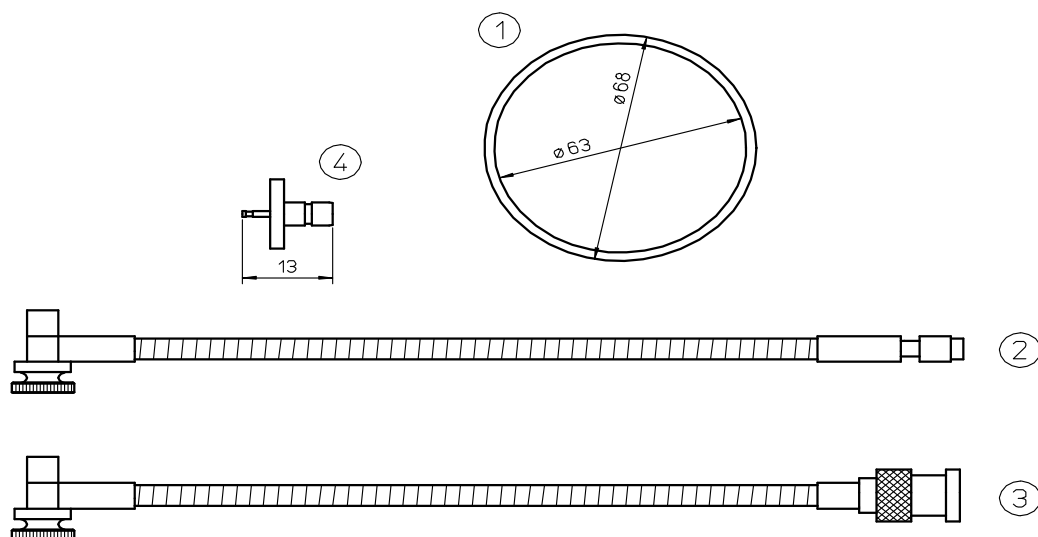

POS	II-VI p/n	OEM p/n	DESCRIPTION
1	AL56		AMADA® GASKET TEFLON FOR SENSOR HEAD
2	AL200	71341630	AMADA® CONNECTING CABLE HS 5
3	AL260	71398965	AMADA® CONNECTING CABLE HS-15 FO
4	AL263		AMADA® SENSOR CABLE CONNECTOR

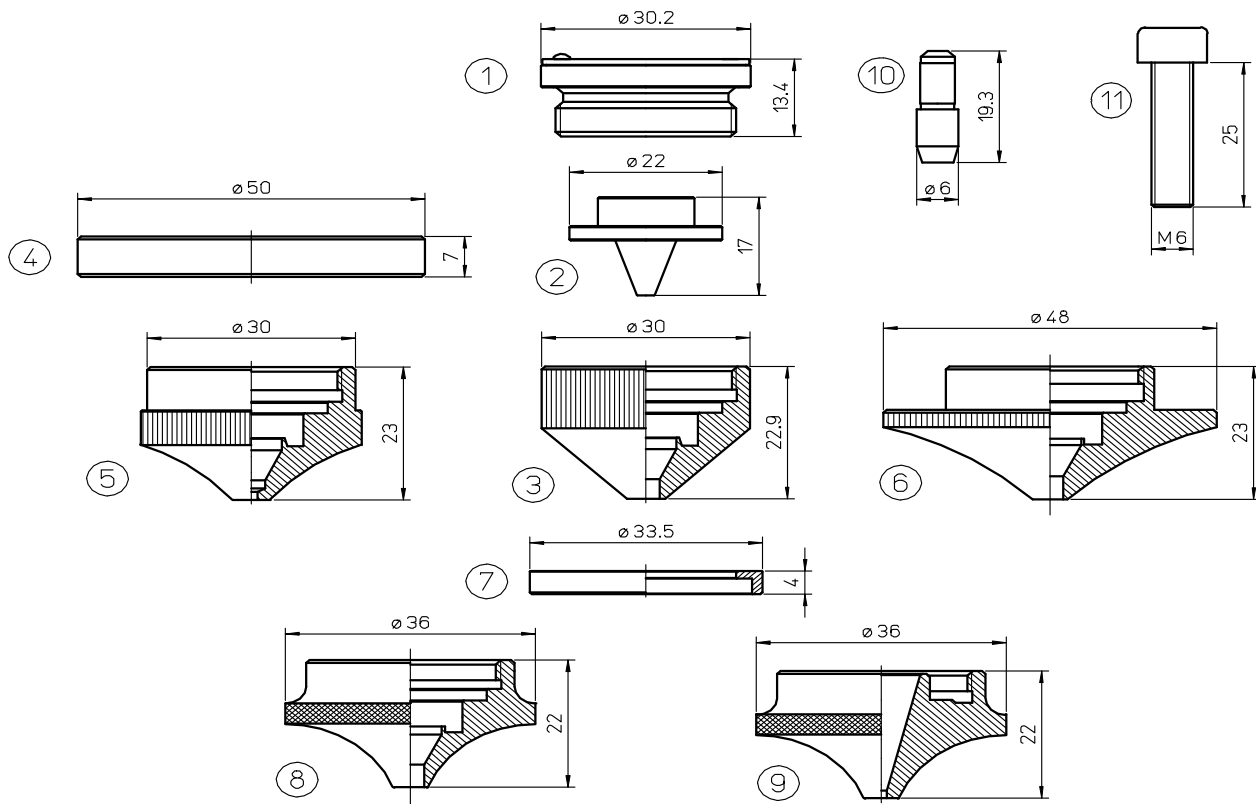

SEE NEXT PAGE (PG. 16) FOR PART NUMBERS

POS	II-VI p/n	OEM p/n	DESCRIPTION
1	AL267	P0594-860-00001	PRECITEC® NOZZLE HOLDER IT HP2" MZP/MEL
2	L1119	71800023 - BQ943D156H01	AMADA® DOUBLE NOZZLE 8 HOLES Ø 1.5
	L1123	71800024 - BQ943D156H03	AMADA® DOUBLE NOZZLE 24 HOLES Ø 1.5
	L1120		AMADA® DOUBLE NOZZLE 8 HOLES Ø 2.0
	L1124		AMADA® DOUBLE NOZZLE 24 HOLES Ø 2.0
3	AL238	71800027 - BQ933D221H04-P0593-860-00001	AMADA® - MITSUBISHI® SHIELD CUP SHORT
4	AL297		AMADA® - MITSUBISHI® PLASTIC RING
5	AL302		AMADA® - MITSUBISHI® OUTER NOZZLE Ø 1.7
	AL303		AMADA® - MITSUBISHI® OUTER NOZZLE Ø 2.0
	AL304		AMADA® - MITSUBISHI® OUTER NOZZLE Ø 2.5
	AL305		AMADA® - MITSUBISHI® OUTER NOZZLE Ø 3.0
	AL306		AMADA® - MITSUBISHI® OUTER NOZZLE Ø 4.0
6	AL266	BQ933D044H01-71800101-W18Q93304401	MITSUBISHI® OUTER NOZZLE HIGH SPEED PIERCE
8	AL270	71802197 - BQ933D044H01	AMADA® - MITSUBISHI® OUTER NOZZLE
7	AL341-T	71800155TF - BQ023D021H01	AMADA® - MITSUBISHI® TEFLON INSULATION RING
	AL341-A	71800155AL - BQ023D021H01	AMADA® - MITSUBISHI® ALUMINUM INSULATION RING
9	L1262	7180015400 - BQ023D020H01	AMADA® NOZZLE HIGH SPEED PIERCE Ø 1.7
10	AL345	71800009 - P921K000P25 - JPZA5-6	AMADA® SAFETY PIN
11	AL346	71800008 - L249OA005	AMADA® SAFETY SCREW

SEE PREVIOUS PAGE (PG. 15) FOR PART DRAWINGS

II-VI INFRARED

... the world leader in CO₂ laser optics

FOR ALL OF YOUR REPLACEMENT OPTIC NEEDS

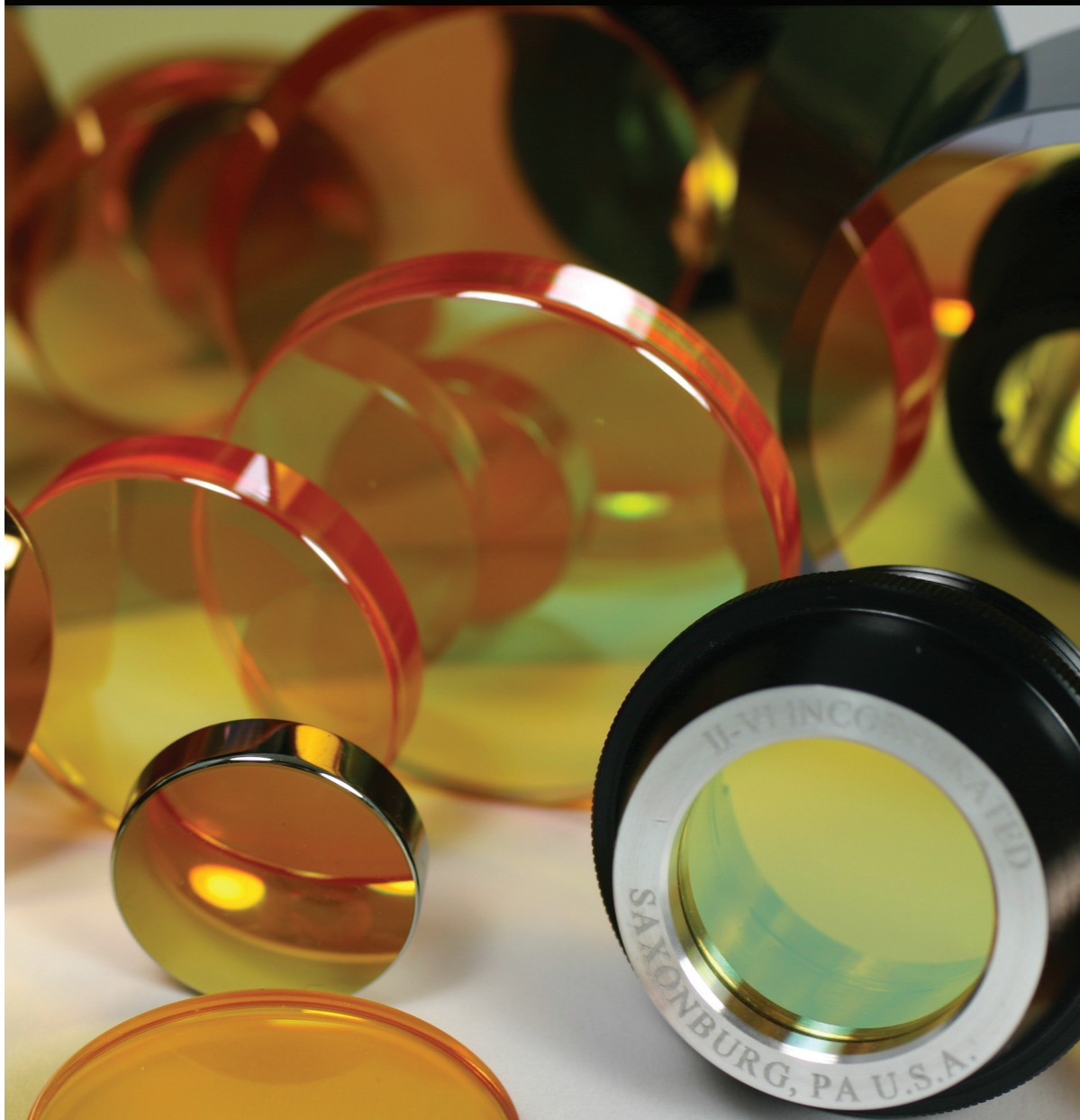

888.558.1504 (toll-free) • 724.352.1504 (phone) • 724.352.4980 (fax) • www.iiviinfrared.com

II-VI

BEYOND NOZZLES

HOW TO ORDER

If you are unsure of what nozzles you need contact our trained staff for assistance.

Customers in the USA and Canada can call toll-free: 888.558.1504.

Customers outside of the USA and Canada can call: 724.352.1504.

Customers in Europe and Asia can also contact a II-VI Subsidiary Office (see back cover for details).

Catalog revised January 2010 and copyrighted by II-VI Incorporated.

All orders received by II-VI Incorporated ("II-VI") are expressly conditioned upon the following conditions of sale:

1) Acceptance

Any additional or different terms set forth in any purchase order or other communication from Buyer are objected to and not binding upon II-VI unless and until accepted in writing by an authorized representative of II-VI.

2) Standard Warranty

II-VI warrants to the Buyer of each product of II-VI's own manufacture ("Product") that each Product will be free from defects in materials and workmanship subject to the following conditions:

The obligations of II-VI under this Standard Warranty shall be limited to either, at the option of II-VI: (1) the replacement or repair of any Product upon the shipment of such Product, freight prepaid by Buyer to the II-VI factory; or (2) the provision to Buyer of a credit against future purchases in an amount equal to the purchase price of the defective Product.

IN NO EVENT WILL II-VI BE LIABLE FOR ANY INCIDENTAL OR CONSEQUENTIAL DAMAGES OF BUYER. THE FOREGOING REMEDIES ARE THE SOLE AND EXCLUSIVE REMEDY OF BUYER FOR ANY BREACH OF WARRANTY UNDER THIS CONTRACT.

All claims under this Standard Warranty must be made within ONE (1) YEAR after the date on which the Product was delivered to Buyer. In the case of a replacement or repair of a Product, Buyer shall only ship a defective Product to II-VI after an authorized representative of II-VI has provided a Return Authorization (RA) number for such warranty claim. Returns will be subject to a restocking fee.

With respect to such returns, Buyer is solely responsible for properly packaging any Product to be returned to II-VI under this Standard Warranty. Products must be packaged in their original manufacturer's packaging or equivalent. Products must be packaged in separate shipping containers with Return Authorization (RA) numbers clearly marked on the outside of the shipping containers. If there are questions regarding proper packaging and shipping, contact II-VI for guidelines. II-VI will not be responsible for replacing or repairing any Product damaged while in transit to II-VI due to faulty or deficient packaging.

This Standard Warranty shall be void and shall not apply with respect to any Product which, upon inspection by II-VI, shows evidence of damage as a result of abuse, misuse, mishandling, accidental damage, alteration, negligent handling, or improper installation or application, or as a result of alteration or other causes beyond the control of II-VI.

This Standard Warranty shall not apply to goods or parts included in or supplied with Products; such goods or parts carry only such warranties, if any, as are provided by the manufacturers of such goods or parts, which warranties may be more restrictive than the Standard Warranty provided by II-VI.

With respect to any previously-purchased Product, II-VI shall have no obligation to install updates or upgrades to any components in such Product, even if the exclusion of such updates or upgrades of such components renders such Product obsolete when compared to a new Product of a substantially similar type.

THERE ARE NO WARRANTIES THAT EXTEND BEYOND THE DESCRIPTION CONTAINED HEREIN. THIS WARRANTY VOIDS AND EXCLUDES ANY AND ALL OTHER WARRANTIES OR REPRESENTATIONS, WHETHER EXPRESS OR IMPLIED OR ARISING UNDER ANY LAW, RELATING TO THE GOODS, INCLUDING BUT NOT LIMITED TO WARRANTIES OF MERCHANTABILITY AND/OR FITNESS FOR ANY PARTICULAR PURPOSES.

NO PERSON, FIRM, OR CORPORATION IS AUTHORIZED TO ASSUME ON BEHALF OF II-VI ANY ADDITIONAL OBLIGATION OR LIABILITY NOT EXPRESSLY PROVIDED HEREIN, EXCEPT IN A WRITING DULY EXECUTED BY AN OFFICER OF II-VI.

3) Limitation of Liability

In no event shall II-VI be liable for any incidental or consequential damages. The liability of II-VI on any claim of any kind shall in no event exceed the price of the Product which gives rise to the claim. Except as to title, all such liability shall terminate upon expiration of the warranty period of the Product.

The invalidity of any of the previous paragraphs shall not affect the remainder of this paragraph or any other paragraph in this section.

4) Patent Infringement

Buyer shall hold II-VI harmless against any expense or loss resulting from infringement of patents or trademarks arising from compliance with Buyer's designs or specifications.

5) Delivery and Title

Delivery dates are approximate and are based upon prompt receipt of all necessary information from Buyer. Under no circumstances does II-VI guarantee date of shipment.

Unless otherwise specified by II-VI, shipment will be made and title will pass F.O.B. point of shipment. II-VI shall ship Products as it deems appropriate unless instructed otherwise in writing by Buyer.

6) Risk of Loss

Risk of loss or damage shall pass to Buyer upon shipment. Loss or damage that occurs during shipping by a carrier selected by Buyer is Buyer's responsibility.

7) Uncontrollable Delays

II-VI shall not be liable for delivery delays due to causes beyond its reasonable control including, but not limited to, acts of God, acts of Buyer, acts of military authority, governmental priorities, labor strikes, and transportation delays.

8) Financial Conditions

If II-VI determines in good faith that the financial condition of Buyer at any time does not justify the continuation of production or shipment on the terms of payment originally specified, II-VI may require full or partial payment in advance. In the event of Buyer bankruptcy or insolvency, II-VI shall be entitled to cancel any outstanding order and shall receive reimbursement for its cancellation charges.

9) Payment Terms

Unless terms are specifically set forth on the Order Acknowledgement, Buyer shall pay at such time and such terms as specified in II-VI's original invoice. Any quotations shall be valid for the period stated on the quotation.

10) Cancellation

Buyer may not cancel its order after shipment has been made. Buyer may cancel its order prior to shipment only upon written notice and consent of II-VI. If II-VI consents to any such cancellation, Buyer may be required to pay cancellation charges which include lost profits and all expenses incurred in connection with the cancelled order.

11) Jurisdiction

The validity, performance, and all matters relating to the interpretation and effect of this agreement shall be governed by the laws of the Commonwealth of Pennsylvania.

WORLDWIDE SALES OFFICES

To place an order, contact a II-VI sales representative at any of the following locations, or log onto www.iiviinfrared.com/contact for our most complete and up-to-date contact information.

II-VI INFRARED

375 SAXONBURG BLVD
SAXONBURG, PA 16056
UNITED STATES

888-558-1504 (toll-free in USA)
724-352-1504 (phone)
724-352-4980 (fax)
info@iiviinfrared.com (email)

II-VI WEST

36570 BRIGGS ROAD
MURRIETA, CA 92563
USA
800.262.5273 (toll free in USA)
951.926.7640 (phone)
951.926.1984 (fax)
info@iiviinfrared.com

II-VI BENELUX N.V.

BAAIKENSSTRAAT 21/2
9240 ZELE
BELGIUM

32 (0) 52 45 86 10 (phone)
32 (0) 52 45 86 11 (fax)
sales@ii-vi.be (email)

II-VI DEUTSCHLAND GmbH

IM TIEFEN SEE 58
D-64293 DARMSTADT
GERMANY

49 6151 880 629 (phone)
49 6151 896 667 (fax)
info@ii-vi.de (email)

II-VI ITALIA S.r.l.

VIA ANDREA COSTA
31-20131 MILANO
ITALY

39 02 28995701 (phone)
39 02 26149131 (fax)
info@ii-vi.it (email)

II-VI SUISSE S.a.r.l.

MOULIN-DU-CHOC
1122 ROMANEL-SUR-MORGES
SWITZERLAND

41 2186 902 52 (phone)
41 2186 993 08 (fax)
info@ii-vi-lot.ch (email)

II-VI UK LTD.

21 BURLEY ROAD
OAKHAM, RUTLAND
LE15 6DH
ENGLAND

44 1572 771 778 (phone)
44 1572 771 779 (fax)
salesii-vi@oakham.uk.com (email)

II-VI JAPAN

WBG MARIVE EAST 17F
2-6 NAKASE, MIHAMA-KU
CHIBA-SHI, CHIBA 261-7117
JAPAN

81 43297 2693 (phone)
81 43297 3003 (fax)
center@ii-vi.co.jp (email)

II-VI SINGAPORE PTE. LTD.

BLK. 5012, TECHPLACE II
#04-07 & 05-07/12,
ANG MO KIO AVE. 5
SINGAPORE 569876

65 6481 8215 (phone)
65 6481 8702 (fax)
info@ii-vi.com.sg (email)

II-VI TRADING (SUZHOU) CO. LTD.

BLOCK D#01-01/04
NO. 5 XING HANS STREET
SUZHOU INDUSTRIAL PARK
SUZHOU, CHINA 215021

86 512 6761 9295 (phone)
86 512 6767 1207 (fax)
twosix@ii-vi.com.cn (email)

www.iiviinfrared.com