

# Adaptable Orca

**Referencia en negrita**  
**producto disponible**  
 Otras referencias  
 consúltenos

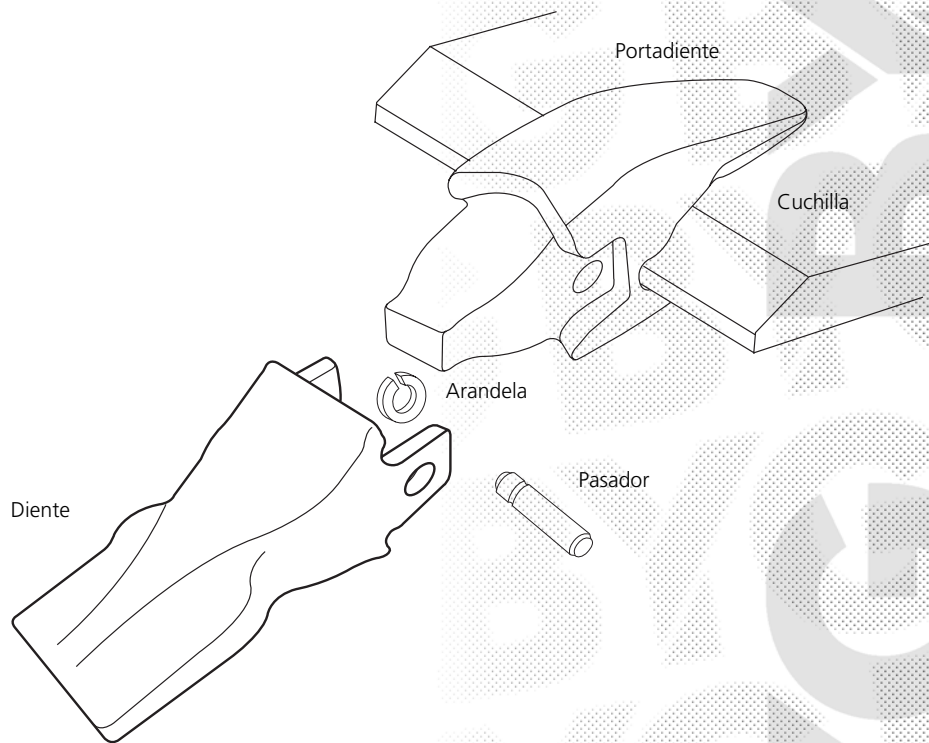

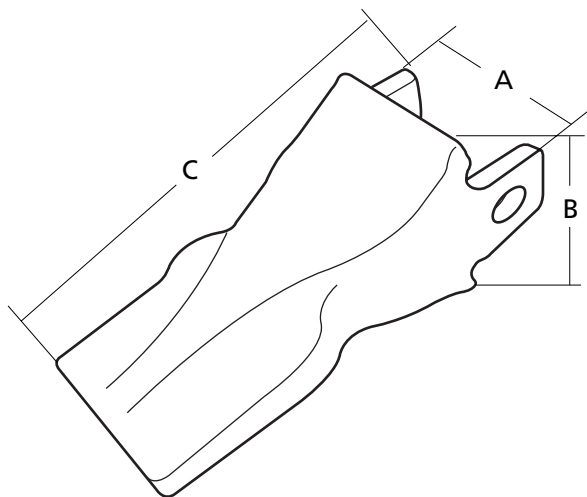

## Diente Orca

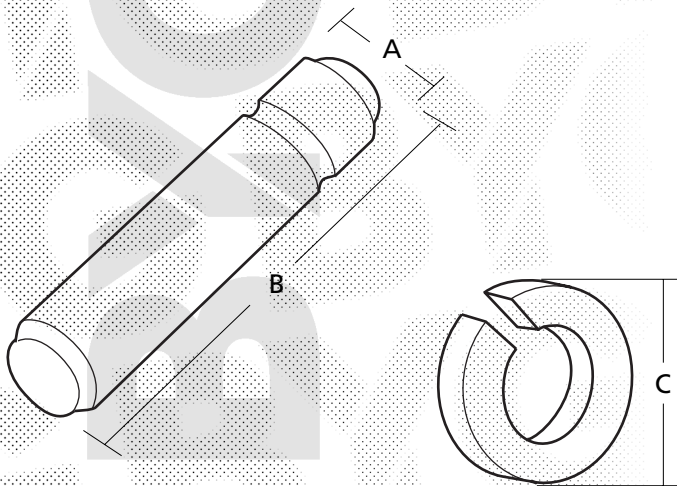

mm.										
A	B	C								
-	-	-	-	-	<b>71407828</b> 22TLR	2MF-22P	2MF-21/22R	71407829	FH-120, EX-135, FH-200, EX-215	<b>22</b>
-	-	-	-	-	<b>71417992</b> 24TLR	2MF-24P	2MF-24R	71417993	FH-200, EX-215	<b>24</b>
116 4,57"	111 4,37"	316 12,44"	40 1,57"	7,10 15,65	<b>71421565</b> 26TLR	2MF-26P	2MF-26/28R	71421566	FH-220, EX-240, FH-270, FH-300, FH-330	<b>26</b>
-	-	-	-	-	<b>71432195</b> 28TLR	2MF-28P	2MF-26/28R	71432196	FH-400, EX-450	<b>28</b>

## Pasador y Arandela

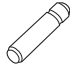

mm.					
A	B	C			
10	85	18	<b>2MF-22P</b>	<b>2MF-21/22R</b>	<b>22</b>
14	102	27	<b>2MF-24P</b>	<b>2MF-24R</b>	<b>24</b>
19	122	32	<b>2MF-26P</b>	<b>2MF-26/28R</b>	<b>26</b>
19	135	32	<b>2MF-28P</b>	<b>2MF-26/28R</b>	<b>28</b>

## Equivalencias entre Marcas: Dientes, Pasadores y Arandelas

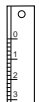
Dientes Ref. BYG	Fiat Antigua	Fiat Moderna	Esco	Feurst®	
71407828	71467241	71407828	022SL	22TLR	<b>22</b>
71417992	71465120	71419992	024SL	24TLR	<b>24</b>
<b>71421565</b>	71464186	71421565	026SL	26TLR	<b>26</b>
71432195	71468101	17432195	028SL	28TLR	<b>28</b>

Pasadores Ref. BYG	Pasadores Ref. Fiat Antiguos	Pasadores Ref. Fiat Modernos	Esco	Feurst®	Fixmet®	
<b>2MF-22P</b>	71467242	71407832	022PN	22CL	2MF-22P	<b>22</b>
<b>2MF-24P</b>	71465124	71417996	024PN	24CL	2MF-24P	<b>24</b>
<b>2MF-26P</b>	71464190	71421569	026PN	26CL	2MF-26P	<b>26</b>
<b>2MF-28P</b>	71468105	71432199	028PN	28CL	2MF-28P	<b>28</b>

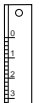
Arandelas Ref. BYG	Fiat Antiguas	Fiat Modernas	Esco	Feurst®	Fixmet®	
<b>2MF-21/22R</b>	71467243	71407833	022LK	22RD	2MF-21/22R	<b>22</b>
<b>2MF-24R</b>	71465125	71417997	024LK	24RD	2MF-24R	<b>24</b>
<b>2MF-26 / 28R</b>	71464191	71421570	026-28LK	26RD	2MF-26 / 28R	<b>26</b>
<b>2MF-26 / 28R</b>	71464191	71432200	026-28LK	28RD	2MF-26 / 28R	<b>28</b>