

- 1. Cabezal
- 2. Eje tracción
- 3. Carrete
- 4. Cinta tracción
- 5. Escalera

- 6. Soporte
- 7. Lama
- 8. Guía
- 9. Motor
- 10. Terminal

**Tabla de repliegue**

Repliegue	Altura luz
16	80
17	100
19	120
20	140
21	160
22	180
23	200
25	220
26	240
27	260
28	280
30	300
31	320
32	340
33	360
34	380
36	400
37	420
38	440
39	460

**Lama C80**

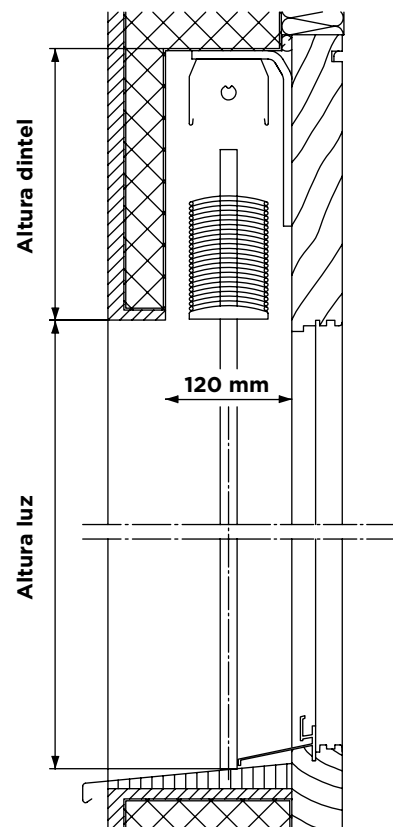
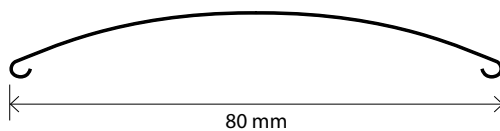

**Límites dimensionales**

Accionamiento	Límites dimensionales	
	Manivela	Motor
Ancho mínimo (cm)	50	60
Ancho máximo veneciana (cm)	300	450
Alto máximo (cm)	400	450
Superficie máxima veneciana (m <sup>2</sup> )	12	16

**Aluminio Perfilado. Aleación 3105H18**

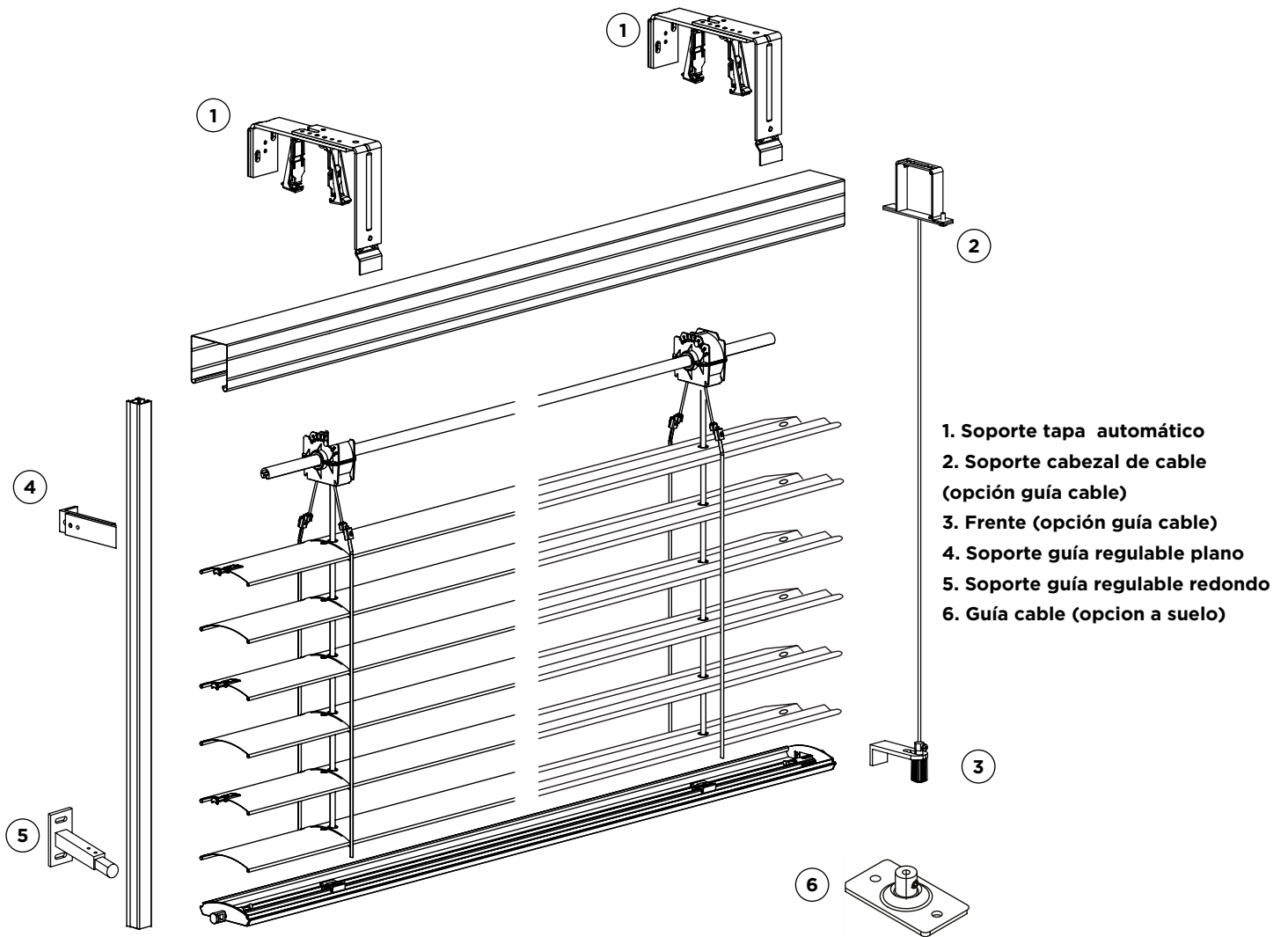

## Guías compatibles

**Guía Lateral**  
20 x 20 mm

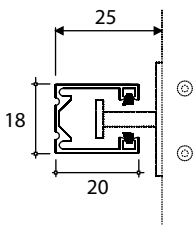

**Guía Frontal**  
22 x 20 mm

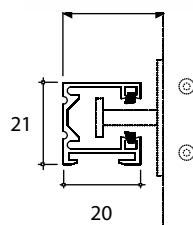

**Guía Frontal**  
40 x 20 mm reforzada  
autoportante

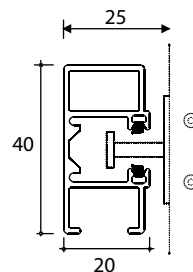

**Guía Frontal Doble**  
40 x 22 mm

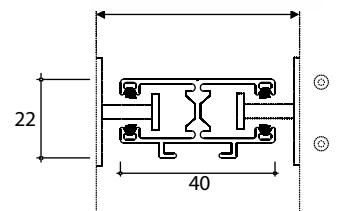

# Tapas de repliegue

## Tapa Simple

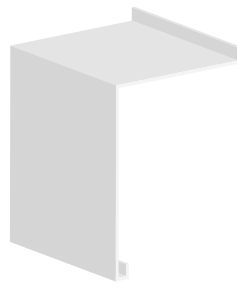

S-1

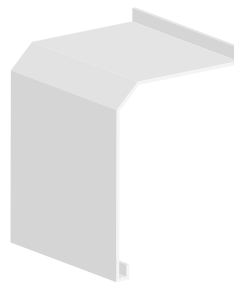

S-2



S-3

## Tapa Doble

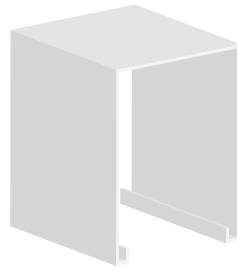

D-1

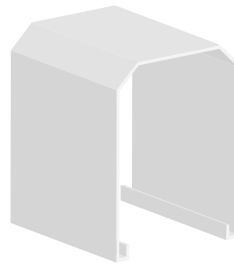

D-2



D-3

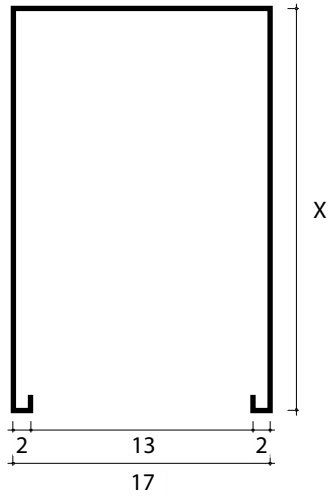

**Guía Frontal Doble  
40 x 40 mm reforzada  
autoportante**

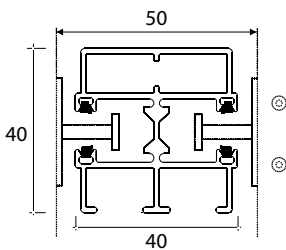

**Guía Redonda  
40 mm reforzada**

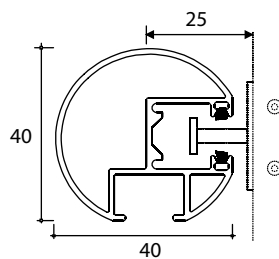

**Guía Redonda Doble  
40 mm reforzada**

